

Central operator-MC PRO

⚠ IMPORTANT! Please read instructions fully before installation

1 - DRILLING THE TUBE

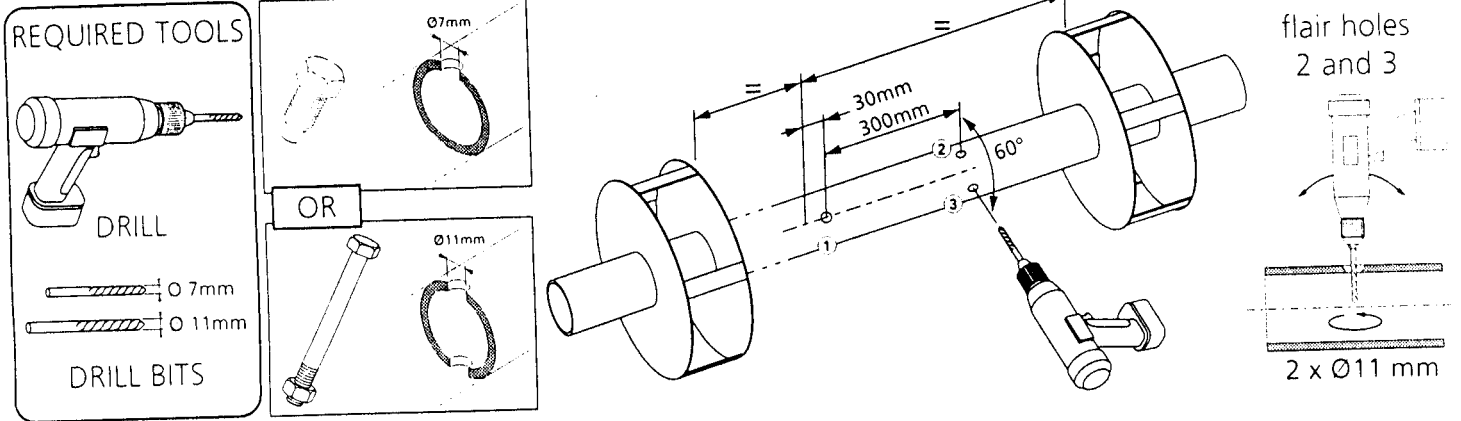

2 - ATTACHING THE OPERATOR

Remove the drive ring. Position the operator on the tube and slide the clamp on as shown below.

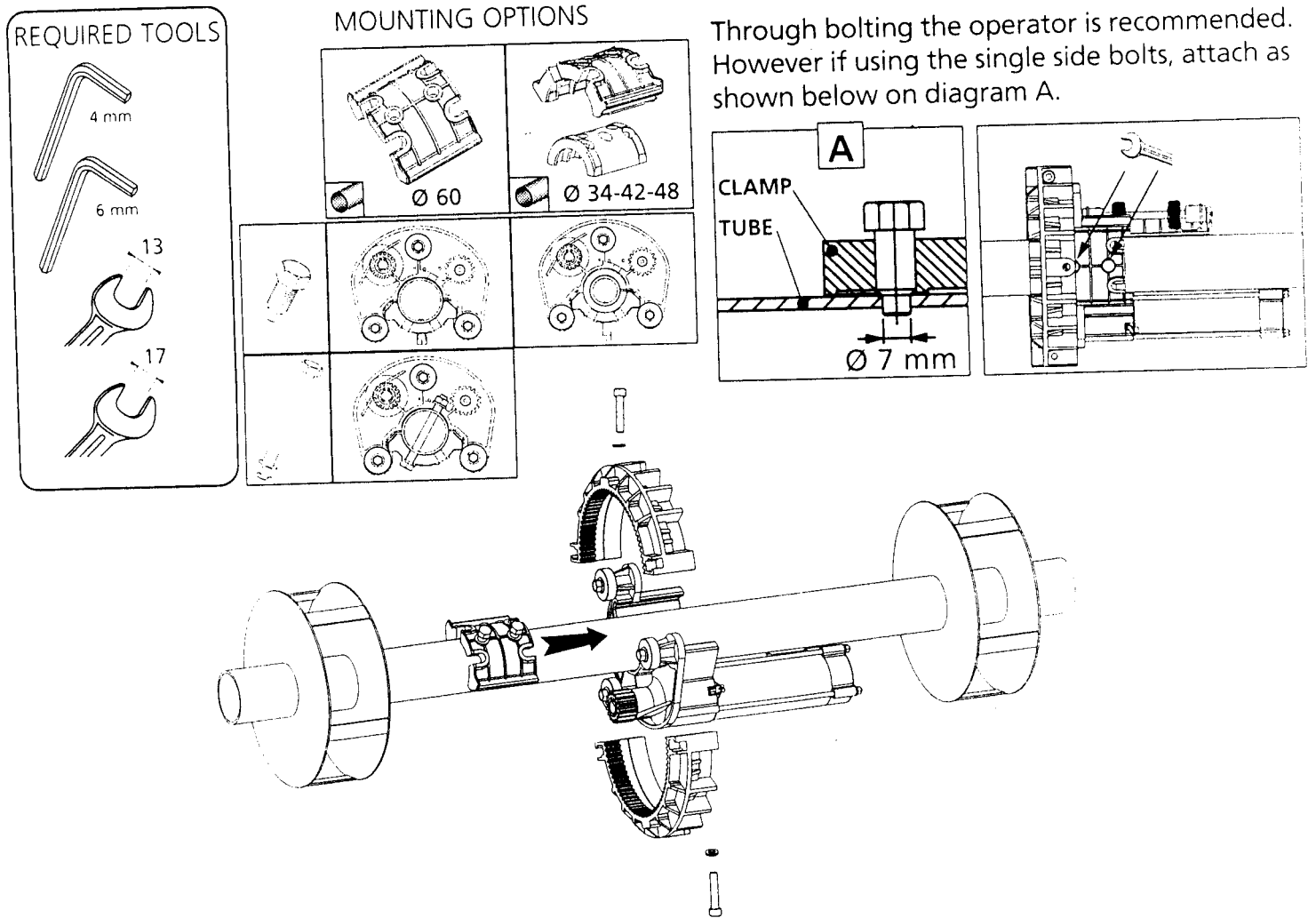

3 - ROUTING CABLES

Rout the power and brake release cables throught the prepared holes and out the tube side away from the drive ring as shown on the diagram below.

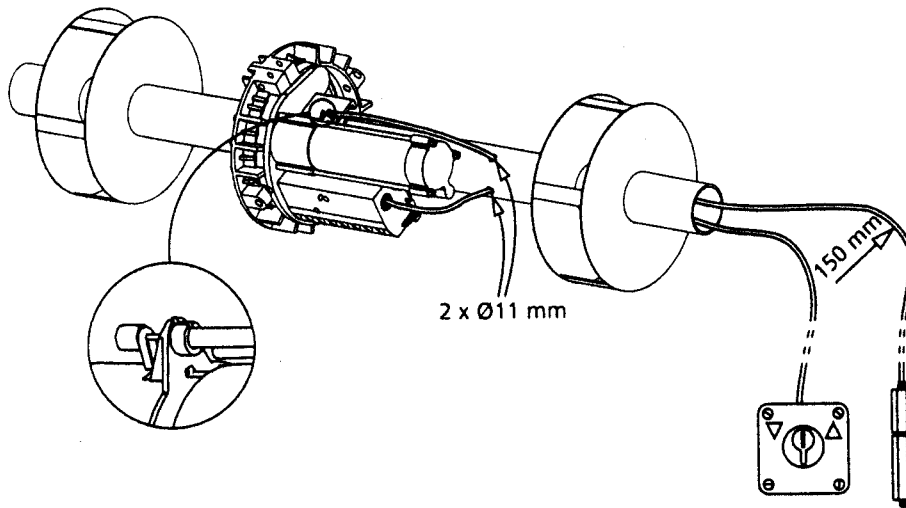

IMPORTANT !

To prevent binding of the brake release cable, do not bend it tighter than a 150mm (6 inch.) radius

4 - ELECTRICAL CONNECTIONS

WARNING :
TURN OFF POWER AT THE BREAKER WHEN MAKING ELECTRICAL CONNECTIONS.

Connect the central operator to the control device. A standard key switch is shown. Do not connect more than one operator to a single set of contacts. For other control options, contact SIMU. After connecting the operator to the control, test the direction of rotation. If the operator turns in the wrong direction, reverse the red and black motor leads.

REQUIRED TOOLS

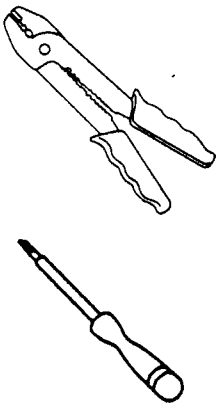

120V-60Hz	
⊕	GREEN
①	RED
②	WHITE
③	BLACK

