

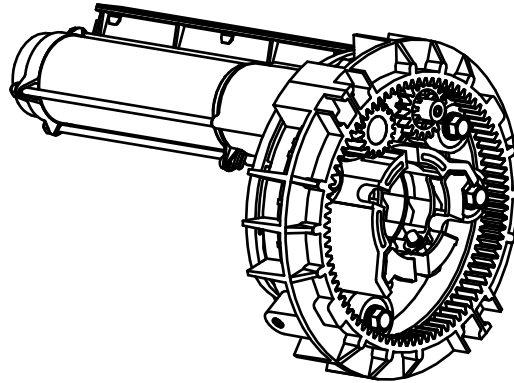

Operators Type Central (120V - 60Hz) AC

- Fast set limits
- 6 feet of motor cable
- 6 cycles per hour
- UL Recognized
- CSA Approved
- Brake release



Operators

Approximate shipping weight = 25 lb.

New Reference	Old Reference	Crown size (in.)	Speed (rpm)	Watts	Amps	Limit Switch (max. turns)	Run Time (minutes)
2001098	400151	8	12	420	3.4	13	4
2001099	400152	9	12	420	3.4	13	4

- Central operators come standard with 2-3/8" fixed shaft. Adaptors are available for smaller diameters.
- Maximum counter balanced weight is 450 lbs on reference number 2001098 and 400 lbs on reference number 2001099.

Installation at a Glance

